

ms Eurodam

DECK PLANS & STATEROOMS

The deck plans are color-coded by category of stateroom, and the category letter precedes the stateroom number in each room. All staterooms are equipped with flat-panel television, mini-bar, DVD player, mini-safe, data port, telephone and multichannel music.

Important Note: Not all staterooms within each category have the same furniture configuration and/or facilities. Appropriate symbols within the rooms on the deck plans describe differences from the stateroom descriptions below.

All information is subject to change.

STATEROOM SYMBOL LEGEND

- Triple (2 lower beds, 1 sofa bed)
- Quad (2 lower beds, 1 sofa bed, 1 upper)
- △ Partial sea view
- X Fully obstructed view
- + Connecting rooms
- * Shower only
- ♣ Single sink vanity, bathtub only
- ♠ Single sink vanity
- ◆ Staterooms have solid steel verandah railings instead of clear-view Plexiglas® railings
- ♿ Suites SA7058 & SA7057 are wheelchair accessible, bathtub and roll-in shower. Suites SY5002 & SY5001 and staterooms VA8119, VA8116, I-8033, VA8026, VA8025, V6052, V6049, VB6002, VB6001, V5140, V5135, V5054, V5051, VA4134, VA4131, H4092, H4089, VA4052, VA4051, D1100, D1099, C1082, C1081, J1074, K1012 & K1011 are wheelchair accessible, roll-in shower only.

OCEAN-VIEW STATEROOMS

C **D** **DD** **E** **F**

Large: 2 lower beds convertible to 1 queen-size bed, bathtub & shower.
Approximately 169–267 sq. ft.

INTERIOR STATEROOMS

J **K**

Large or Standard: 2 lower beds convertible to 1 queen-size bed, shower.
Approximately 141–284 sq. ft.

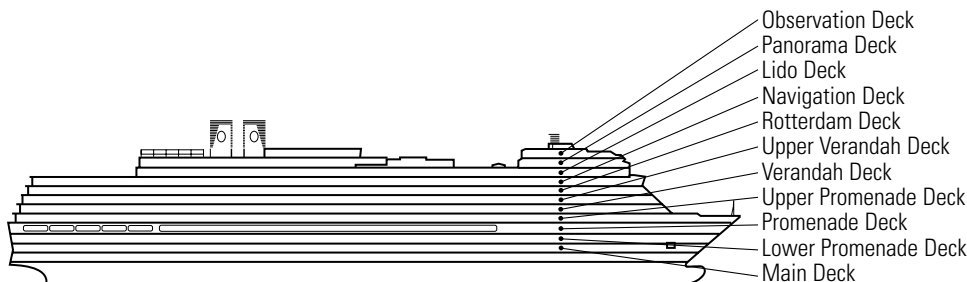

DECK 1 – MAIN DECK

Staterooms 1001–1130

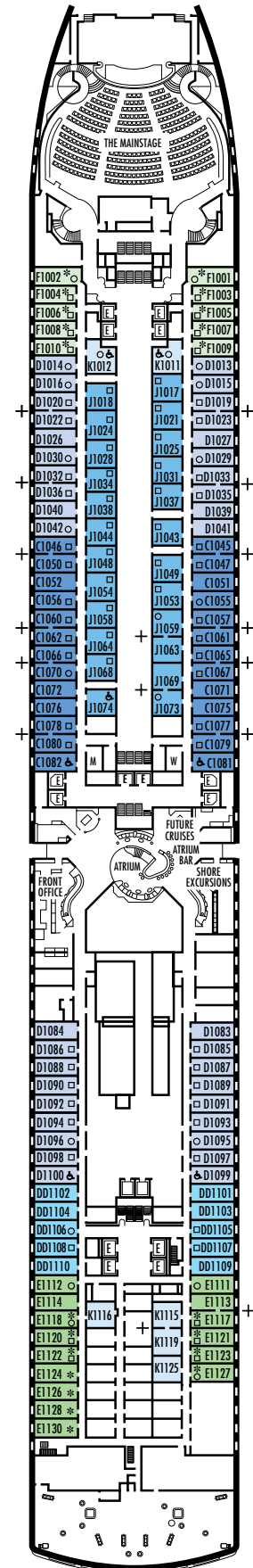

ms Eurodam

DECK PLANS & STATEROOMS

The deck plans are color-coded by category of stateroom, and the category letter precedes the stateroom number in each room. All staterooms are equipped with flat-panel television, mini-bar, DVD player, mini-safe, data port, telephone and multichannel music.

Important Note: Not all staterooms within each category have the same furniture configuration and/or facilities. Appropriate symbols within the rooms on the deck plans describe differences from the stateroom descriptions below.

All information is subject to change.

STATEROOM SYMBOL LEGEND

- Triple (2 lower beds, 1 sofa bed)
- Quad (2 lower beds, 1 sofa bed, 1 upper)
- △ Partial sea view
- × Fully obstructed view
- + Connecting rooms
- * Shower only
- ♣ Single sink vanity, bathtub only
- ♠ Single sink vanity
- ◆ Staterooms have solid steel verandah railings instead of clear-view Plexiglas® railings
- ♿ Suites SA7058 & SA7057 are wheelchair accessible, bathtub and roll-in shower. Suites SY5002 & SY5001 and staterooms VA8119, VA8116, I-8033, VA8026, VA8025, V6052, V6049, VB6002, VB6001, V5140, V5135, V5054, V5051, VA4134, VA4131, H4092, H4089, VA4052, VA4051, D1100, D1099, C1082, C1081, J1074, K1012 & K1011 are wheelchair accessible, roll-in shower only.

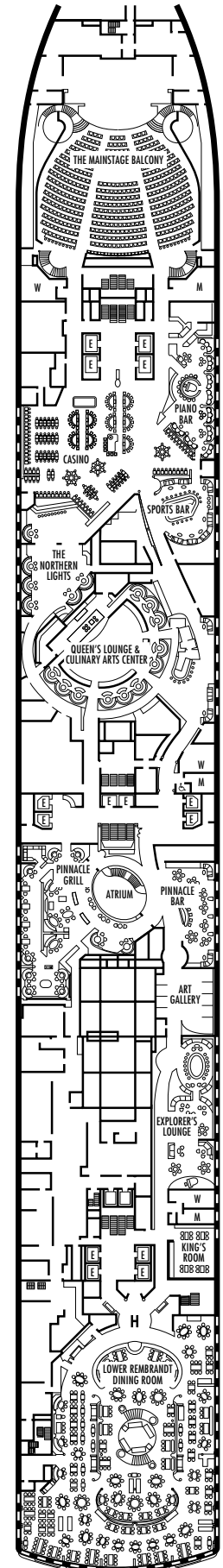
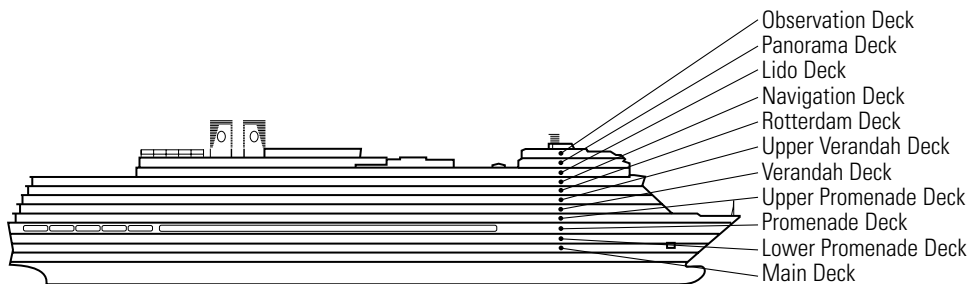

ms Eurodam

DECK PLANS & STATEROOMS

The deck plans are color-coded by category of stateroom, and the category letter precedes the stateroom number in each room. All staterooms are equipped with flat-panel television, mini-bar, DVD player, mini-safe, data port, telephone and multichannel music.

Important Note: Not all staterooms within each category have the same furniture configuration and/or facilities. Appropriate symbols within the rooms on the deck plans describe differences from the stateroom descriptions below.

All information is subject to change.

STATEROOM SYMBOL LEGEND

- Triple (2 lower beds, 1 sofa bed)
- Quad (2 lower beds, 1 sofa bed, 1 upper)
- △ Partial sea view
- × Fully obstructed view
- + Connecting rooms
- * Shower only
- ♣ Single sink vanity, bathtub only
- ♠ Single sink vanity
- ◆ Staterooms have solid steel verandah railings instead of clear-view Plexiglas® railings
- ♿ Suites SA7058 & SA7057 are wheelchair accessible, bathtub and roll-in shower. Suites SY5002 & SY5001 and staterooms VA8119, VA8116, I-8033, VA8026, VA8025, V6052, V6049, VB6002, VB6001, V5140, V5135, V5054, V5051, VA4134, VA4131, H4092, H4089, VA4052, VA4051, D1100, D1099, C1082, C1081, J1074, K1012 & K1011 are wheelchair accessible, roll-in shower only.

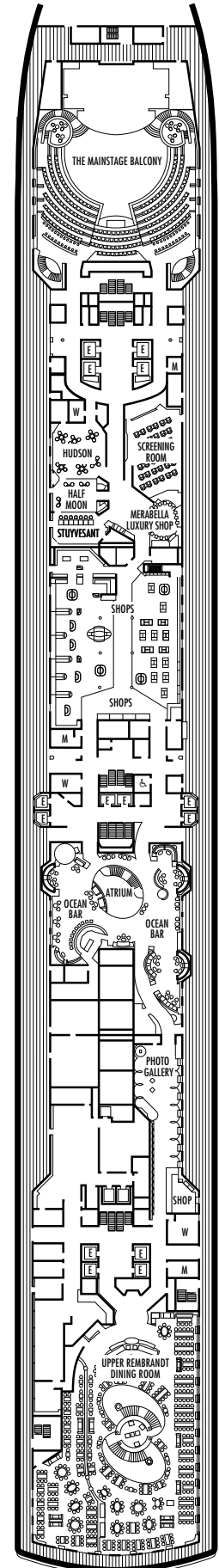
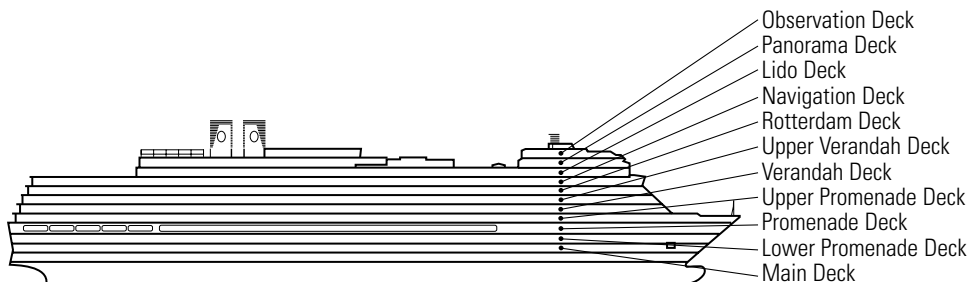

ms Eurodam

DECK PLANS & STATEROOMS

The deck plans are color-coded by category of stateroom, and the category letter precedes the stateroom number in each room. All staterooms are equipped with flat-panel television, mini-bar, DVD player, mini-safe, data port, telephone and multichannel music.

Important Note: Not all staterooms within each category have the same furniture configuration and/or facilities. Appropriate symbols within the rooms on the deck plans describe differences from the stateroom descriptions below.

All information is subject to change.

STATEROOM SYMBOL LEGEND

- Triple (2 lower beds, 1 sofa bed)
- Quad (2 lower beds, 1 sofa bed, 1 upper)
- △ Partial sea view
- × Fully obstructed view
- + Connecting rooms
- * Shower only
- ♣ Single sink vanity, bathtub only
- ♠ Single sink vanity
- ◆ Staterooms have solid steel verandah railings instead of clear-view Plexiglas® railings
- ♿ Suites SA7058 & SA7057 are wheelchair accessible, bathtub and roll-in shower. Suites SY5002 & SY5001 and staterooms VA8119, VA8116, I-8033, VA8026, VA8025, V6052, V6049, VB6002, VB6001, V5140, V5135, V5054, V5051, VA4134, VA4131, H4092, H4089, VA4052, VA4051, D1100, D1099, C1082, C1081, J1074, K1012 & K1011 are wheelchair accessible, roll-in shower only.

VERANDAH SUITES

SB

Neptune Suites: 2 lower beds convertible to 1 king-size bed, bathroom with dual-sink vanity, full-size whirlpool bath & shower & additional shower stall, large sitting area, dressing room, private verandah, 1 sofa bed for 2 persons, floor-to-ceiling windows. Approximately 506–590 sq. ft. including verandah.

VERANDAH STATEROOMS

VA VB VC VE VF VH

Verandah: 2 lower beds convertible to 1 queen-size bed, bathtub & shower, sitting area, private verandah, floor-to-ceiling windows. Approximately 213–379 sq. ft. including verandah.

OCEAN-VIEW STATEROOMS

G H HH

Large: 2 lower beds convertible to 1 queen-size bed, bathtub & shower. All G-category staterooms have partial sea views. All H- & HH-category staterooms have fully obstructed views. Approximately 169–267 sq. ft.

INTERIOR STATEROOMS

I

Large: 2 lower beds convertible to 1 queen-size bed, shower. Approximately 141–284 sq. ft.

K

Large or Standard: 2 lower beds convertible to 1 queen-size bed, shower. Approximately 141–284 sq. ft.

L N

Standard: 2 lower beds convertible to 1 queen-size bed, shower. Approximately 141–284 sq. ft.

DECK 4—UPPER PROMENADE DECK

Staterooms 4001–4187

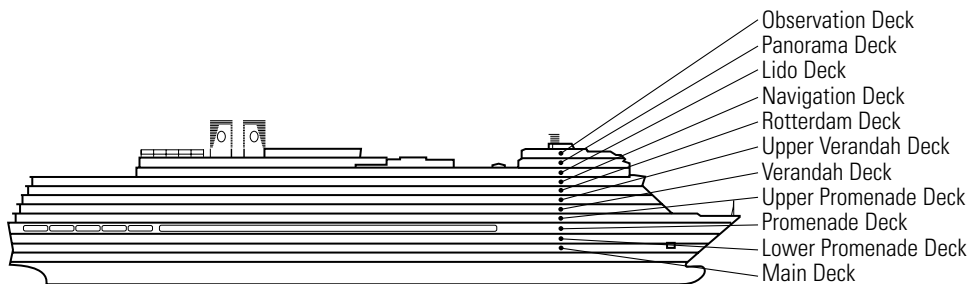
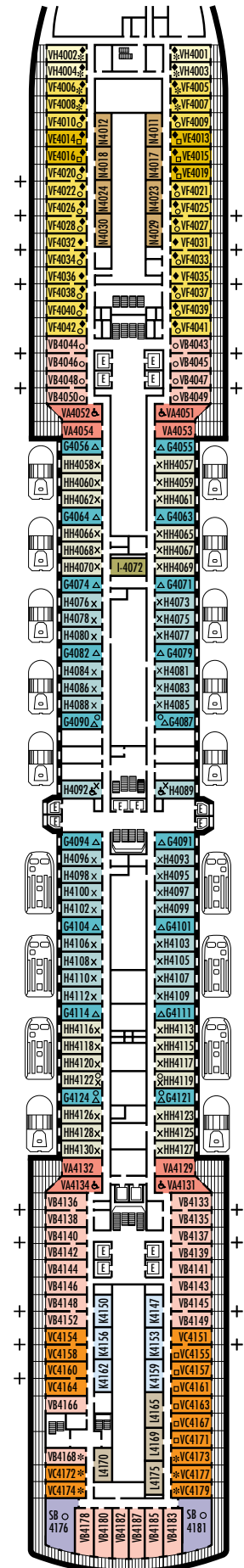

ms Eurodam

DECK PLANS & STATEROOMS

The deck plans are color-coded by category of stateroom, and the category letter precedes the stateroom number in each room. All staterooms are equipped with flat-panel television, mini-bar, DVD player, mini-safe, data port, telephone and multichannel music.

Important Note: Not all staterooms within each category have the same furniture configuration and/or facilities. Appropriate symbols within the rooms on the deck plans describe differences from the stateroom descriptions below.

All information is subject to change.

STATEROOM SYMBOL LEGEND

- Triple (2 lower beds, 1 sofa bed)
- Quad (2 lower beds, 1 sofa bed, 1 upper)
- △ Partial sea view
- × Fully obstructed view
- + Connecting rooms
- * Shower only
- ♣ Single sink vanity, bathtub only
- ♠ Single sink vanity
- ◆ Staterooms have solid steel verandah railings instead of clear-view Plexiglas® railings
- ♿ Suites SA7058 & SA7057 are wheelchair accessible, bathtub and roll-in shower. Suites SY5002 & SY5001 and staterooms VA8119, VA8116, I-8033, VA8026, VA8025, V6052, V6049, VB6002, VB6001, V5140, V5135, V5054, V5051, VA4134, VA4131, H4092, H4089, VA4052, VA4051, D1100, D1099, C1082, C1081, J1074, K1012 & K1011 are wheelchair accessible, roll-in shower only.

VERANDAH SUITES

SB

Neptune Suites: 2 lower beds convertible to 1 king-size bed, bathroom with dual-sink vanity, full-size whirlpool bath & shower & additional shower stall, large sitting area, dressing room, private verandah, 1 sofa bed for 2 persons, floor-to-ceiling windows. Approximately 506–590 sq. ft. including verandah.

SS SY

Signature Suites: 2 lower beds convertible to 1 queen-size bed, bathroom with dual-sink vanity, full-size whirlpool bath & shower & additional shower stall, large sitting area, private verandah, 1 sofa bed for 1 person, floor-to-ceiling windows. Approximately 273–456 sq. ft. including verandah.

VERANDAH STATEROOMS

V VB VC

Verandah: 2 lower beds convertible to 1 queen-size bed, bathtub & shower, sitting area, private verandah, floor-to-ceiling windows. Approximately 213–379 sq. ft. including verandah.

INTERIOR STATEROOMS

I

Large: 2 lower beds convertible to 1 queen-size bed, shower. Approximately 141–284 sq. ft.

K

Large or Standard: 2 lower beds convertible to 1 queen-size bed, shower. Approximately 141–284 sq. ft.

L

Standard: 2 lower beds convertible to 1 queen-size bed, shower. Approximately 141–284 sq. ft.

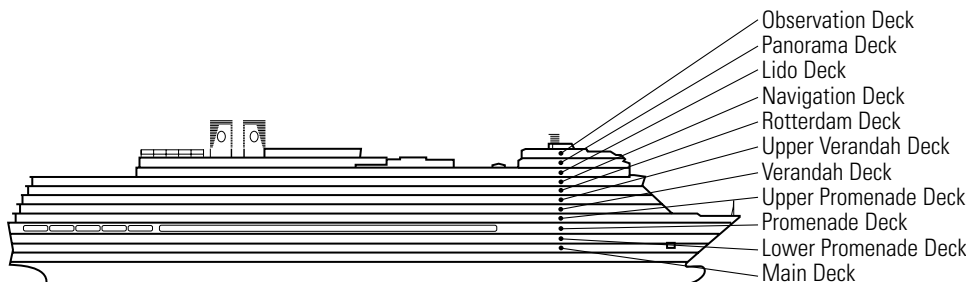
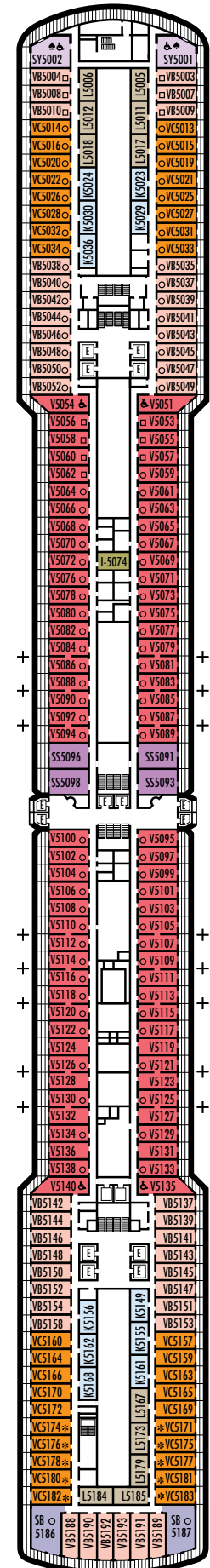

ms Eurodam

DECK PLANS & STATEROOMS

The deck plans are color-coded by category of stateroom, and the category letter precedes the stateroom number in each room. All staterooms are equipped with flat-panel television, mini-bar, DVD player, mini-safe, data port, telephone and multichannel music.

Important Note: Not all staterooms within each category have the same furniture configuration and/or facilities. Appropriate symbols within the rooms on the deck plans describe differences from the stateroom descriptions below.

All information is subject to change.

STATEROOM SYMBOL LEGEND

- Triple (2 lower beds, 1 sofa bed)
- Quad (2 lower beds, 1 sofa bed, 1 upper)
- △ Partial sea view
- X Fully obstructed view
- + Connecting rooms
- * Shower only
- ♣ Single sink vanity, bathtub only
- ♠ Single sink vanity
- ◆ Staterooms have solid steel verandah railings instead of clear-view Plexiglas® railings
- ♿ Suites SA7058 & SA7057 are wheelchair accessible, bathtub and roll-in shower. Suites SY5002 & SY5001 and staterooms VA8119, VA8116, I-8033, VA8026, VA8025, V6052, V6049, VB6002, VB6001, V5140, V5135, V5054, V5051, VA4134, VA4131, H4092, H4089, VA4052, VA4051, D1100, D1099, C1082, C1081, J1074, K1012 & K1011 are wheelchair accessible, roll-in shower only.

VERANDAH SUITES

SB **SC**

Neptune Suites: 2 lower beds convertible to 1 king-size bed, bathroom with dual-sink vanity, full-size whirlpool bath & shower & additional shower stall, large sitting area, dressing room, private verandah, 1 sofa bed for 2 persons, floor-to-ceiling windows. Approximately 506–590 sq. ft. including verandah.

SS **SY** **SZ**

Signature Suites: 2 lower beds convertible to 1 queen-size bed, bathroom with dual-sink vanity, full-size whirlpool bath & shower & additional shower stall, large sitting area, private verandah, 1 sofa bed for 1 person, floor-to-ceiling windows. Approximately 273–456 sq. ft. including verandah.

VERANDAH STATEROOMS

V **VB** **VC** **VD**

Verandah: 2 lower beds convertible to 1 queen-size bed, bathtub & shower, sitting area, private verandah, floor-to-ceiling windows. Approximately 213–379 sq. ft. including verandah.

OCEAN-VIEW STATEROOMS

F

Large: 2 lower beds convertible to 1 queen-size bed, bathtub & shower. Approximately 169–267 sq. ft.

INTERIOR STATEROOMS

I

Large: 2 lower beds convertible to 1 queen-size bed, shower. Approximately 141–284 sq. ft.

K

Large or Standard: 2 lower beds convertible to 1 queen-size bed, shower. Approximately 141–284 sq. ft.

L

Standard: 2 lower beds convertible to 1 queen-size bed, shower. Approximately 141–284 sq. ft.

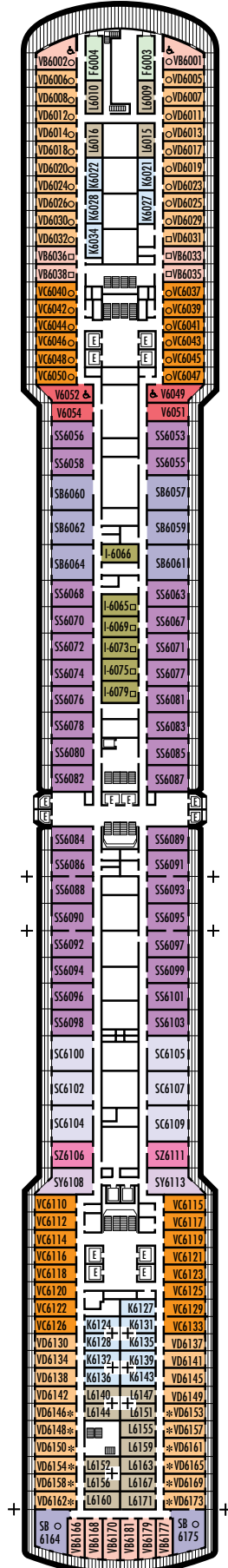
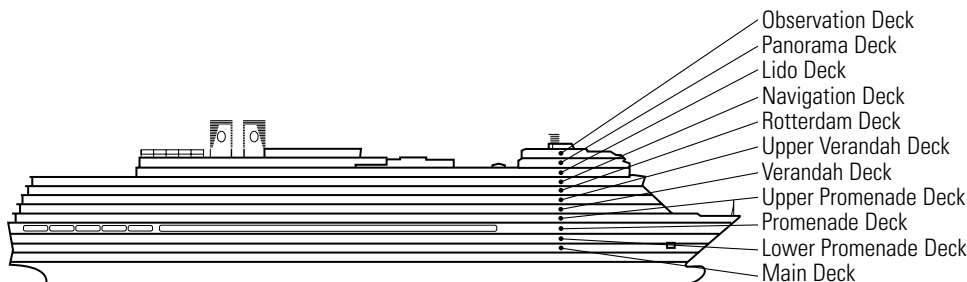

ms Eurodam

DECK PLANS & STATEROOMS

The deck plans are color-coded by category of stateroom, and the category letter precedes the stateroom number in each room. All staterooms are equipped with flat-panel television, mini-bar, DVD player, mini-safe, data port, telephone and multichannel music.

Important Note: Not all staterooms within each category have the same furniture configuration and/or facilities. Appropriate symbols within the rooms on the deck plans describe differences from the stateroom descriptions below.

All information is subject to change.

STATEROOM SYMBOL LEGEND

- Triple (2 lower beds, 1 sofa bed)
- Quad (2 lower beds, 1 sofa bed, 1 upper)
- △ Partial sea view
- X Fully obstructed view
- + Connecting rooms
- * Shower only
- ♣ Single sink vanity, bathtub only
- ♠ Single sink vanity
- ◆ Staterooms have solid steel verandah railings instead of clear-view Plexiglas® railings
- ♿ Suites SA7058 & SA7057 are wheelchair accessible, bathtub and roll-in shower. Suites SY5002 & SY5001 and staterooms VA8119, VA8116, I-8033, VA8026, VA8025, V6052, V6049, VB6002, VB6001, V5140, V5135, V5054, V5051, VA4134, VA4131, H4092, H4089, VA4052, VA4051, D1100, D1099, C1082, C1081, J1074, K1012 & K1011 are wheelchair accessible, roll-in shower only.

VERANDAH SUITES

PS

Pinnacle Suites: Bedroom with 1 king-size bed, oversize whirlpool bath & shower & additional shower stall, living room, dining room, dressing room, private verandah with whirlpool, pantry, 1 sofa bed for 2 persons, microwave, refrigerator, guest toilet, private stereo system, floor-to-ceiling windows. Approximately 1,357 sq. ft. including verandah.

SA SB

Neptune Suites: 2 lower beds convertible to 1 king-size bed, bathroom with dual-sink vanity, full-size whirlpool bath & shower & additional shower stall, large sitting area, dressing room, private verandah, 1 sofa bed for 2 persons, floor-to-ceiling windows. Approximately 506–590 sq. ft. including verandah.

SY

Signature Suites: 2 lower beds convertible to 1 queen-size bed, bathroom with dual-sink vanity, full-size whirlpool bath & shower & additional shower stall, large sitting area, private verandah, 1 sofa bed for 1 person, floor-to-ceiling windows. Approximately 273–456 sq. ft. including verandah.

VERANDAH STATEROOMS

VB VD VE

Verandah: 2 lower beds convertible to 1 queen-size bed, bathtub & shower, sitting area, private verandah, floor-to-ceiling windows. Approximately 213–379 sq. ft. including verandah.

INTERIOR STATEROOMS

I

Large: 2 lower beds convertible to 1 queen-size bed, shower. Approximately 141–284 sq. ft.

L M

Standard: 2 lower beds convertible to 1 queen-size bed, shower. Approximately 141–284 sq. ft.

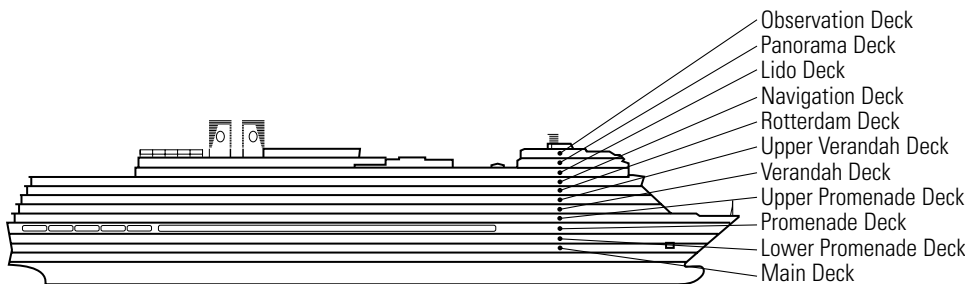
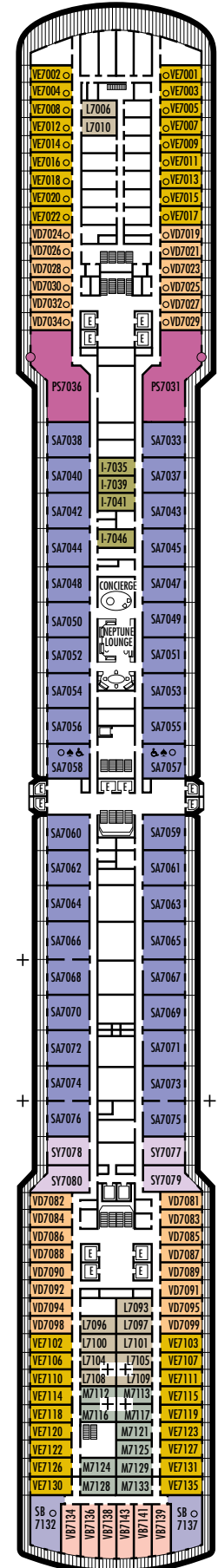

ms Eurodam

DECK PLANS & STATEROOMS

The deck plans are color-coded by category of stateroom, and the category letter precedes the stateroom number in each room. All staterooms are equipped with flat-panel television, mini-bar, DVD player, mini-safe, data port, telephone and multichannel music.

Important Note: Not all staterooms within each category have the same furniture configuration and/or facilities. Appropriate symbols within the rooms on the deck plans describe differences from the stateroom descriptions below.

All information is subject to change.

STATEROOM SYMBOL LEGEND

- Triple (2 lower beds, 1 sofa bed)
- Quad (2 lower beds, 1 sofa bed, 1 upper)
- △ Partial sea view
- X Fully obstructed view
- + Connecting rooms
- * Shower only
- ♣ Single sink vanity, bathtub only
- ♠ Single sink vanity
- ◆ Staterooms have solid steel verandah railings instead of clear-view Plexiglas® railings
- ♿ Suites SA7058 & SA7057 are wheelchair accessible, bathtub and roll-in shower. Suites SY5002 & SY5001 and staterooms VA8119, VA8116, I-8033, VA8026, VA8025, V6052, V6049, VB6002, VB6001, V5140, V5135, V5054, V5051, VA4134, VA4131, H4092, H4089, VA4052, VA4051, D1100, D1099, C1082, C1081, J1074, K1012 & K1011 are wheelchair accessible, roll-in shower only.

VERANDAH SUITES

SB
Neptune Suites: 2 lower beds convertible to 1 king-size bed, bathroom with dual-sink vanity, full-size whirlpool bath & shower & additional shower stall, large sitting area, dressing room, private verandah, 1 sofa bed for 2 persons, floor-to-ceiling windows.
Approximately 506–590 sq. ft. including verandah.

VERANDAH STATEROOMS

VA **VC** **VE** **VF**
Verandah: 2 lower beds convertible to 1 queen-size bed, bathtub & shower, sitting area, private verandah, floor-to-ceiling windows.
Approximately 213–379 sq. ft. including verandah.

INTERIOR STATEROOMS

I
Large: 2 lower beds convertible to 1 queen-size bed, shower.
Approximately 141–284 sq. ft.

MM
Standard: 2 lower beds convertible to 1 queen-size bed, shower.
Approximately 141–284 sq. ft.

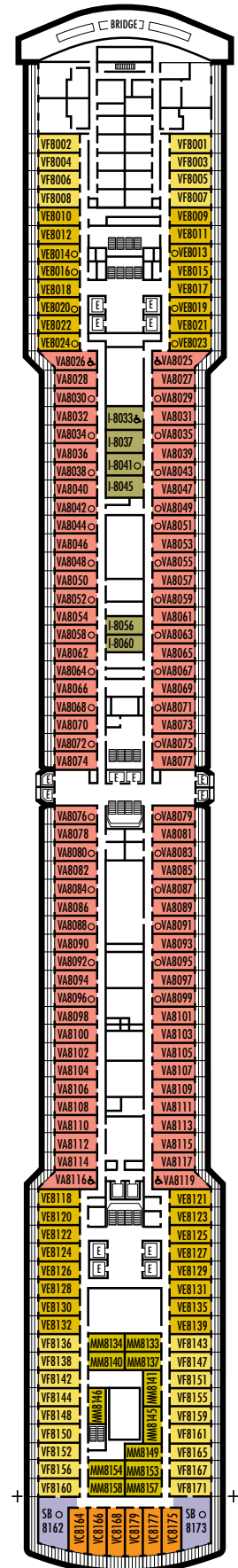
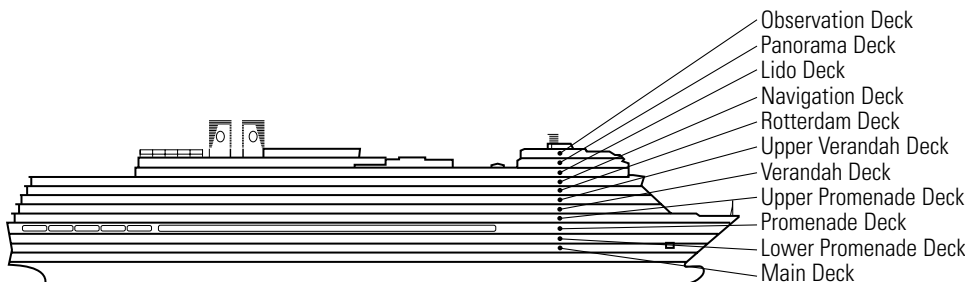

ms Eurodam

DECK PLANS & STATEROOMS

The deck plans are color-coded by category of stateroom, and the category letter precedes the stateroom number in each room. All staterooms are equipped with flat-panel television, mini-bar, DVD player, mini-safe, data port, telephone and multichannel music.

Important Note: Not all staterooms within each category have the same furniture configuration and/or facilities. Appropriate symbols within the rooms on the deck plans describe differences from the stateroom descriptions below.

All information is subject to change.

STATEROOM SYMBOL LEGEND

- Triple (2 lower beds, 1 sofa bed)
- Quad (2 lower beds, 1 sofa bed, 1 upper)
- △ Partial sea view
- × Fully obstructed view
- + Connecting rooms
- * Shower only
- ♣ Single sink vanity, bathtub only
- ♠ Single sink vanity
- ◆ Staterooms have solid steel verandah railings instead of clear-view Plexiglas® railings
- ♿ Suites SA7058 & SA7057 are wheelchair accessible, bathtub and roll-in shower. Suites SY5002 & SY5001 and staterooms VA8119, VA8116, I-8033, VA8026, VA8025, V6052, V6049, VB6002, VB6001, V5140, V5135, V5054, V5051, VA4134, VA4131, H4092, H4089, VA4052, VA4051, D1100, D1099, C1082, C1081, J1074, K1012 & K1011 are wheelchair accessible, roll-in shower only.

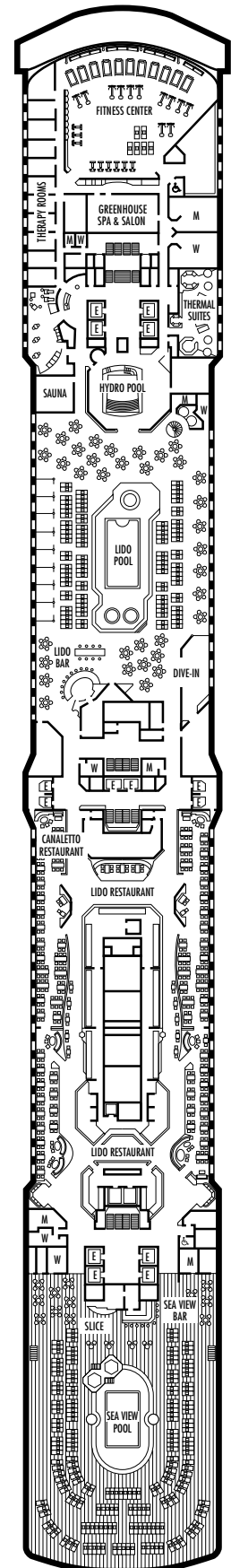
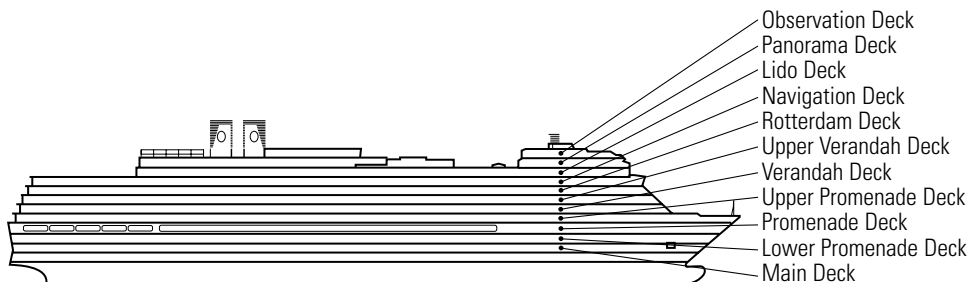

ms Eurodam

DECK PLANS & STATEROOMS

The deck plans are color-coded by category of stateroom, and the category letter precedes the stateroom number in each room. All staterooms are equipped with flat-panel television, mini-bar, DVD player, mini-safe, data port, telephone and multichannel music.

Important Note: Not all staterooms within each category have the same furniture configuration and/or facilities. Appropriate symbols within the rooms on the deck plans describe differences from the stateroom descriptions below.

All information is subject to change.

STATEROOM SYMBOL LEGEND

- Triple (2 lower beds, 1 sofa bed)
- Quad (2 lower beds, 1 sofa bed, 1 upper)
- △ Partial sea view
- × Fully obstructed view
- + Connecting rooms
- * Shower only
- ♣ Single sink vanity, bathtub only
- ♠ Single sink vanity
- ◆ Staterooms have solid steel verandah railings instead of clear-view Plexiglas® railings
- ♿ Suites SA7058 & SA7057 are wheelchair accessible, bathtub and roll-in shower. Suites SY5002 & SY5001 and staterooms VA8119, VA8116, I-8033, VA8026, VA8025, V6052, V6049, VB6002, VB6001, V5140, V5135, V5054, V5051, VA4134, VA4131, H4092, H4089, VA4052, VA4051, D1100, D1099, C1082, C1081, J1074, K1012 & K1011 are wheelchair accessible, roll-in shower only.

VERANDAH SPA SUITES

SU

Signature Spa Suites: 2 lower beds convertible to 1 queen-size bed, bathroom with dual-sink vanity, full-size whirlpool bath & shower & additional shower stall, large sitting area, private verandah, 1 sofa bed for 1 person, floor-to-ceiling windows. Approximately 273–456 sq. ft. including verandah.

VERANDAH SPA STATEROOMS

VQ

Verandah Spa: 2 lower beds convertible to 1 queen-size bed, bathtub & shower, sitting area, private verandah, floor-to-ceiling windows. Approximately 213–379 sq. ft. including verandah.

OCEAN-VIEW SPA STATEROOMS

CQ

Large Ocean-view Spa: 2 lower beds convertible to 1 queen-size bed, bathtub & shower. Approximately 169–267 sq. ft.

INTERIOR SPA STATEROOMS

IQ

Large Interior Spa: 2 lower beds convertible to 1 queen-size bed, shower. Staterooms IQ10043 and IQ10044 have fully obstructed views. Approximately 141–284 sq. ft.

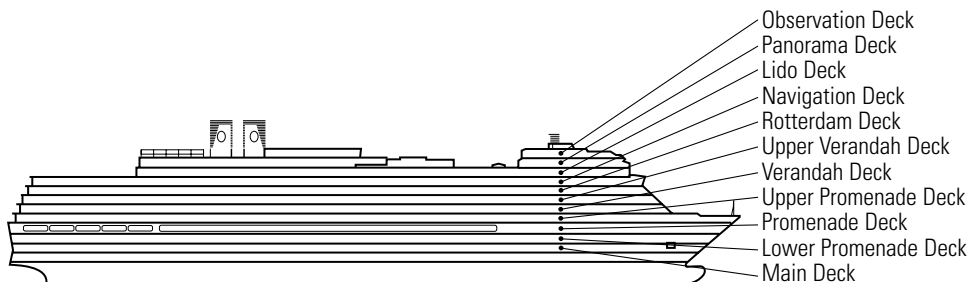
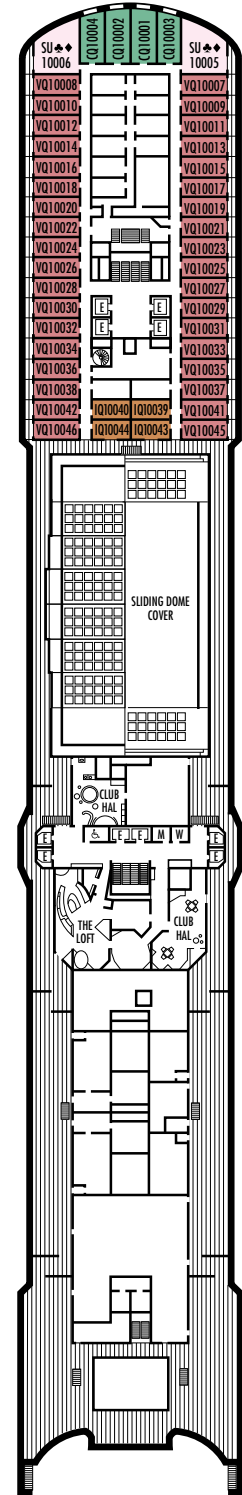

ms Eurodam

DECK PLANS & STATEROOMS

The deck plans are color-coded by category of stateroom, and the category letter precedes the stateroom number in each room. All staterooms are equipped with flat-panel television, mini-bar, DVD player, mini-safe, data port, telephone and multichannel music.

Important Note: Not all staterooms within each category have the same furniture configuration and/or facilities. Appropriate symbols within the rooms on the deck plans describe differences from the stateroom descriptions below.

All information is subject to change.

STATEROOM SYMBOL LEGEND

- Triple (2 lower beds, 1 sofa bed)
- Quad (2 lower beds, 1 sofa bed, 1 upper)
- △ Partial sea view
- × Fully obstructed view
- + Connecting rooms
- * Shower only
- ♣ Single sink vanity, bathtub only
- ♠ Single sink vanity
- ◆ Staterooms have solid steel verandah railings instead of clear-view Plexiglas® railings
- ♿ Suites SA7058 & SA7057 are wheelchair accessible, bathtub and roll-in shower. Suites SY5002 & SY5001 and staterooms VA8119, VA8116, I-8033, VA8026, VA8025, V6052, V6049, VB6002, VB6001, V5140, V5135, V5054, V5051, VA4134, VA4131, H4092, H4089, VA4052, VA4051, D1100, D1099, C1082, C1081, J1074, K1012 & K1011 are wheelchair accessible, roll-in shower only.

VERANDAH SPA STATEROOMS

VT

Verandah Spa: 2 lower beds convertible to 1 queen-size bed, bathtub & shower, sitting area, private verandah, floor-to-ceiling windows. VT staterooms have viewing balconies. Approximately 213–379 sq. ft. including verandah.

